

1 Ground Floor Plan
1 : 100

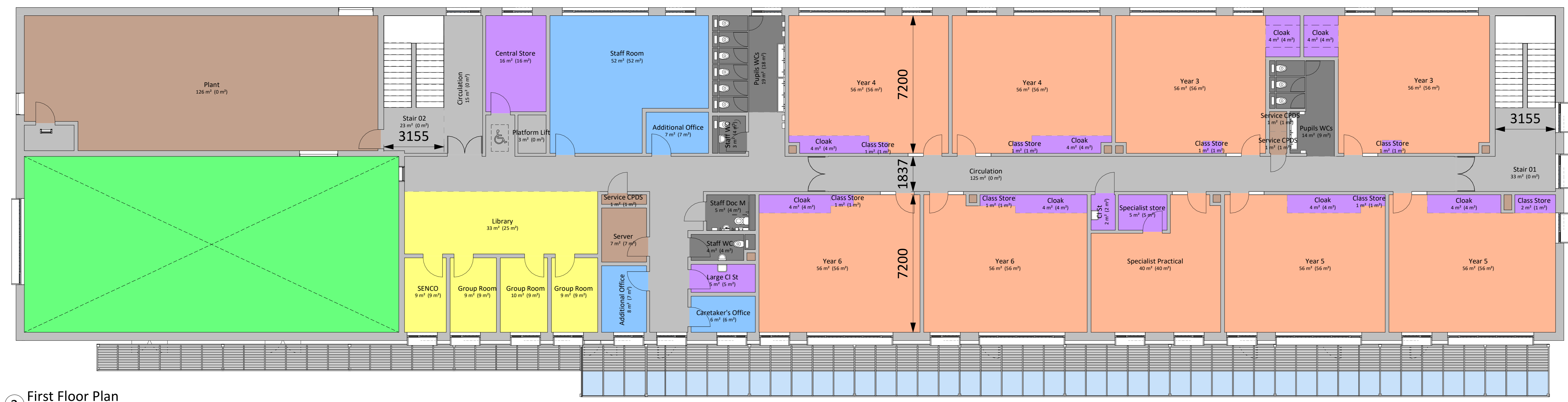

2 First Floor Plan
1 : 100

Floor Plans Summary

- General:**
- Envelope / form simplified further to remove step at Stair 2 and hall, in line with Passivhaus principles
 - Doors have been offset where possible to enable radiators to be positioned behind them to minimise pipe runs in line with Passivhaus principles
- Ground Floor:**
- Nursery area reduced
 - Connection between Nursery and Reception added
 - Entrance to Nursery from secure lobby added
 - Main entrance area and offices replanned
 - Group room relocated upstairs
 - Therapy/MI accessed from dedicated corridor
 - Plant access added for MoE
- First Floor:**
- Additional plant area added
 - Library and office space replanned

Area Schedule (GIA)	
Level	Area
00 Ground Floor	1328 m ²
01 First Floor	1138 m ²
Grand total	2466 m²

Griffin Original Model GIA =	2301m²
Griffin Passivhaus Model GIA =	2466m²
GA Total	2338m ²
Plant	134m ²
Partitions	128m ²
Total GIA Uplift	165m²
GA Uplift	26m ²
Plant Uplift	103m ²
Partitions Uplift	36m ²
Breakdown of GA Uplift	
Staff and Admin	7m ²
WC's	6m ²
Circulation & Stairs	19m ²
Nursery	4m ²
Learning resources	-10m ²

Note: Learning resources is in line with SCC brief

STATUS	REV	DATE	DESCRIPTION	REVISOR
S3	P24	18.01.21	Amendments to nursery kitchen, as contractor instruction 15.01.21	HC
S3	P23	13.01.21	GA amendments as contractor / client instruction 13.01.21 for GA sign off	HC
S3	P22	06.01.21	Revised drawings following SCC and BAM comment	PT
S3	P21	22.12.20	Revised GA's with minor amendments following comment from BAM	PT
S3	P20	21.12.20	Revised GA's following SCC / FFS comments	PT
S3	P19	16.12.20	Revised GA's issued with reduced GIA	PT

CLIENT	REV	DATE	DESCRIPTION	REVISOR
				HC

bam

STRIDE TREGLOWN

www.stridegroup.com © Stride Treglowm Limited 2019

PROJECT
Passivhaus Model

DRAWING TITLE
GA Floor Plans - Timber Frame Build-ups - Reduced GIA

SUITABILITY STATUS	SCALE
S3 : SUITABLE FOR REVIEW & COMMENT	1 : 100@ A0
PROJECT ORIGINATOR ZONE LEVEL TYPE ROLE CLASSIFICATION NUMBER	REVISION
XXXX-STL-00-ZZ-DR-A-SK011	P24